

Power Battery PM2-400 is a general purpose 2v variant of our PM12V series, rated at 400Ah. It's built to the same high standards that distinguish all Power Battery products.

## Power Battery PM2-400

Cells Per Unit	1
Voltage Per Unit	2
Capacity	400Ah@10hr-rate to 1.80V per cell @25°C
Weight	Approx. 26 kg
Max. Discharge Current	2000A (5 sec)
Internal Resistance	Approx. 0.67 mΩ
Operating Temperature Range	Discharge: -20°C~60°C. Charge: 0°C~50°C. Storage: -20°C~60°C.
Normal Operating Temperature Range	25°C ±5°C
Float Charging Voltage	2.27 to 2.3 VDC/unit Average at 25°C
Recommended Max Charging Current Limit	80 A
Equalization and Cycle Service	2.43 to 2.47 VDC/unit Average at 25°C
Self-Discharge	Typically stored for 6 months at 25°C. Self-discharge ratio less than 3% per month at 25°C. Please charge before use.
Terminal	Thread insert & Bolt (F10)

211(L)×176(W)×366(H) (mm)

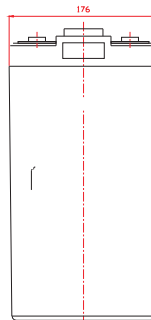
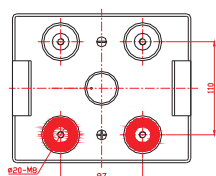
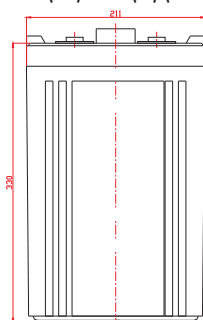

Terminal F10

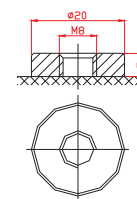

### Constant Current Discharge Characteristics A (25°C)

F.V/Time	15 min	30 min	1 hr	2 hr	3 hr	4 hr	5 hr	6 hr	8 hr	10 hr
1.60V	543.1	400.5	257.8	153.2	114.1	90.97	76.61	64.34	51.94	43.41
1.65V	516.4	384.6	246.6	147.6	109.3	87.78	73.42	62.79	49.61	42.66
1.70V	481.5	362.5	241.8	145.2	106.9	86.98	72.62	61.24	48.84	41.89
1.75V	427.5	326.2	222.6	137.3	101.3	82.19	69.43	58.14	47.29	41.11
1.80V	368.0	297.2	209.9	130.9	97.36	81.40	67.03	57.36	46.51	40.34
1.85V	311.2	267.5	193.9	123.7	92.57	75.01	63.84	54.26	44.19	37.61

### Constant Power Discharge Characteristics W (25°C)

F.V/Time	15 min	30 min	1 hr	2 hr	3 hr	4 hr	5 hr	6 hr	8 hr	10 hr
1.60V	950.8	729.9	472.0	283.8	212.7	171.0	144.8	124.1	98.84	83.81
1.65V	925.9	726.0	470.3	279.7	208.5	168.4	143.1	122.6	98.00	83.02
1.70V	874.6	687.1	461.7	275.6	205.3	167.8	141.9	119.7	96.49	81.73
1.75V	779.1	619.2	425.3	260.9	197.9	159.3	135.9	113.8	93.45	80.42
1.80V	674.3	564.9	401.1	249.2	189.8	158.6	131.5	112.5	91.94	77.56
1.85V	575.0	509.4	370.7	235.9	180.8	146.9	125.5	106.5	87.37	74.68