

Power Battery PM2-1200 is a general purpose 2v variant of our PM12V series, rated at 1200Ah. It's built to the same high standards that distinguish all Power Battery products.



Power Battery PM2-1200

Cells Per Unit	1
Voltage Per Unit	2
Capacity	1200Ah@10hr-rate to 1.80V per cell @25°C
Weight	Approx. 76.0 kg
Max. Discharge Current	4000A (5 sec)
Internal Resistance	Approx. 0.53 mΩ
Operating Temperature Range	Discharge: -20°C~60°C. Charge: 0°C~50°C. Storage: -20°C~60°C.
Normal Operating Temperature Range	25°C ±5°C
Float Charging Voltage	2.27 to 2.3 VDC/unit Average at 25°C
Recommended Max Charging Current Limit	240 A
Equalization and Cycle Service	2.43 to 2.47 VDC/unit Average at 25°C
Self-Discharge	Typically stored for 6 months at 25°C. Self-discharge ratio less than 3% per month at 25°C. Please charge before use.
Terminal	Thread insert & Bolt (F10)

475(L)×175(W)×368(H) (mm)

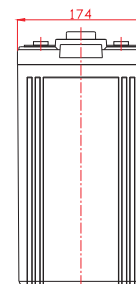
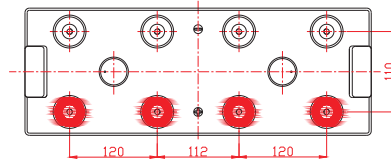
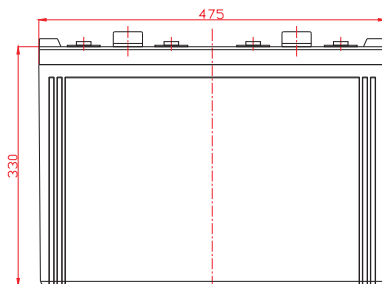

Terminal F10

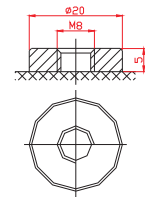

Constant Current Discharge Characteristics A (25°C)

F.V/Time	15 min	30 min	1 hr	2 hr	3 hr	4 hr	5 hr	6 hr	8 hr	10 hr
1.60V	1629	1202	773.3	459.6	342.3	272.9	229.8	193.0	155.8	130.2
1.65V	1549	1154	739.7	442.9	328.0	263.3	220.2	188.4	148.8	128.0
1.70V	1445	1088	725.4	435.7	320.8	260.9	217.9	183.7	146.5	125.7
1.75V	1283	978.7	667.9	411.8	304.0	246.6	208.3	174.4	141.9	123.3
1.80V	1104	891.5	629.6	392.6	292.1	244.2	201.1	172.1	139.5	121.0
1.85V	933.7	802.6	581.7	371.1	277.7	225.0	191.5	162.8	132.6	112.8

Constant Power Discharge Characteristics W (25°C)

F.V/Time	15 min	30 min	1 hr	2 hr	3 hr	4 hr	5 hr	6 hr	8 hr	10 hr
1.60V	2852	2190	1416	851.5	638.0	512.9	434.3	372.4	296.5	251.4
1.65V	2778	2178	1411	839.2	625.5	505.2	429.4	367.7	294.0	249.1
1.70V	2624	2061	1385	826.9	615.9	503.3	425.6	359.1	289.5	245.2
1.75V	2337	1858	1276	782.8	593.8	478.0	407.8	341.4	280.4	241.3
1.80V	2023	1695	1203	747.6	569.3	475.8	394.5	337.4	275.8	232.7
1.85V	1725	1528	1112	707.7	542.3	440.7	376.5	319.6	262.1	224.0